

# 701

san marco

suite  
**6E**

36,033 SF

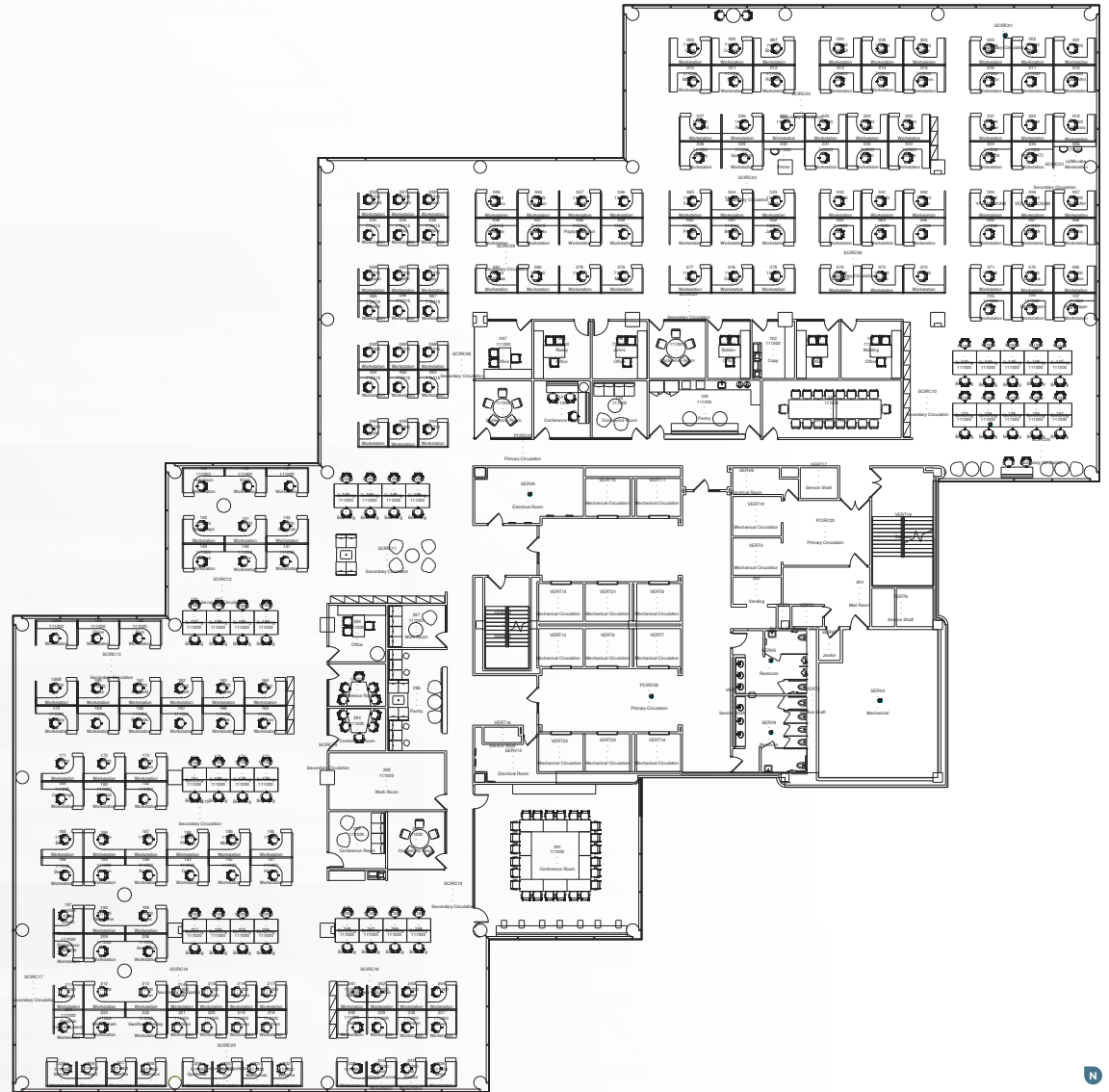

owned + managed by

**BA** BRADFORD ALLEN

leased by

**JLL**

**PRESTON PHILLIPS**

(904) 559-3916

preston.phillips@am.jll.com

**JESSE SHIMP**

(904) 559-3910

jesse.shimp@am.jll.com

**MICHAEL LOFTIN**

(904) 559-3911

michael.loftin@am.jll.com